

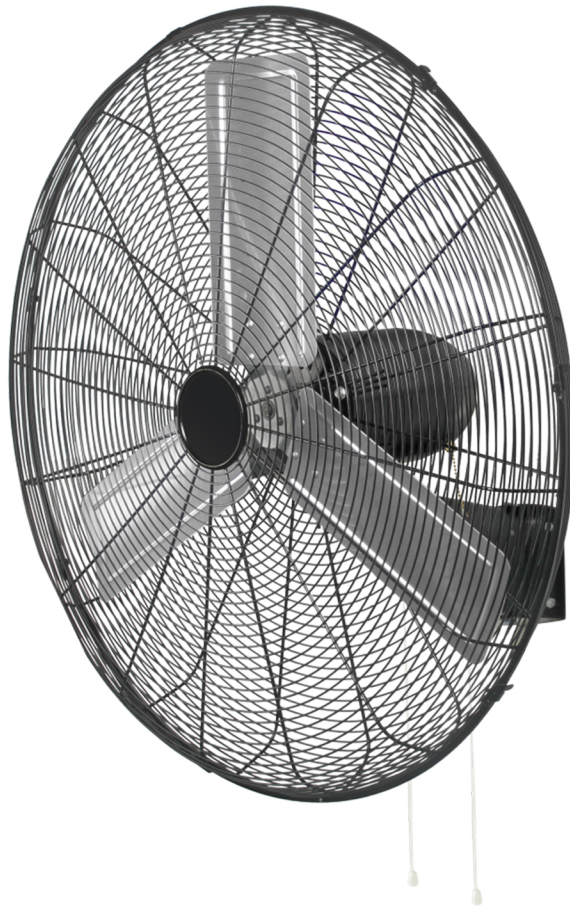

User Manual

24" & 30" Oscillating Wall Fan

Models: FFWM24-O-DP & FFWM30-O-DP



PLEASE READ AND SAVE THESE INSTRUCTIONS

Attention: Pictures in this manual are for reference only.

MADE IN CHINA

INTENDED USE

This product is intended for indoor residential, office, industrial, or other commercial applications. Use only with electrical wiring that is in good working order and that meets applicable codes and ordinances. If you have any questions whether your wiring is adequate, consult a qualified electrician.

While using your fan, you should follow the **IMPORTANT INSTRUCTIONS** listed below. As part of those instructions, we have used the word "**WARNING**" to indicate the level of hazard: WARNING indicates a hazard which, if not avoided, could result in injury or death.

IMPORTANT INSTRUCTIONS

As with all electrical appliances, basic safety precautions should always be followed to reduce the risk of electric shock, fire, or injury to persons, including the following precautions:

- Read all the instructions before using this fan.
- Use this fan only as described in this manual. Any other use not recommended by the manufacturer may cause electrical shock, fire or injury to persons.
- Do not operate the fan with a damaged power cord or after the fan malfunctions or has been dropped in any manner.
- Use of extreme caution is necessary when any fan is used by or near children, disabled persons or pets and whenever the fan is left operating unattended.
- Do not place the fan on a small, unlevel, uneven or any surface which might allow fan to tip or fall.
- For proper operation, fan should be placed on a smooth, non- combustible, level surface.
- Always unplug fan when not in use, when moving from place to place, when assembling or disassembling parts, and before cleaning.
- The use of attachments, not recommended or sold by the manufacturer, may cause hazards.
- Do not use outdoors.
- Do not use fan in window. Rain may cause electrical hazard (for non-window models).
- Do not operate the fan with blade guards or any safety device removed.
- Do not run power cord under carpeting. Do not cover cord with throw rugs, runners or the like. Arrange cord away from traffic area where it will not be tripped over.
- Do not insert or allow any object to enter any openings on the fan. Doing so may cause electric shock and/or fire hazard. Avoid contact with moving parts.

READ & SAVE THESE INSTRUCTIONS

WARNING: Shock Hazard

Use your fan only in dry environments. This fan is not intended for use in a bathroom, laundry area, or similar locations, or near sinks, washing machines, swimming pools or other sources of water. Never locate fan where it may fall into a bathtub or other water receptacle. Do not use in damp environments such as flooded basements.

WARNING: Hot Surfaces

Do not touch fan motor when in use. This motor is hot when in use, to avoid burns, do not let bare skin touch hot surfaces.

WARNING: Fire Hazard

Fans have arcing or sparking parts inside. Do not use near combustible materials or flammable gases or sources of heat. DO NOT USE in areas where gasoline, paint or flammable materials are used or stored. To prevent a possible fire, do not block air intakes or exhaust in any manner.

DO NOT insert or allow foreign objects to enter any ventilation or exhaust opening as this may cause an electric shock, fire, or damage the fan.

WARNING: Electrical Shock Hazard

DO NOT use with damaged cord or plug. Use with adequate electrical system that is up to code.

CAUTION: to Prevent Electric Shock, this product has a three-prong grounded plug that must be inserted into a matching properly grounded outlet to reduce the risk of electrical shock. Do not attempt to defeat this safety feature.

DO NOT operate any fan with a damaged cord or plug or after fan malfunctions, has been dropped or damaged in any manner.

Unplug the fan when not in use. Do not operate fan with its ventilation obstructed.

WARNING:

1. To reduce the risk of fire or electric shock, do not use this fan with any solid-state speed control device.
2. This appliance has a ground plug which is intended to fit in an outlet only one way. If this does not fit outlet contact a qualified electrician. Do not attempt to by-pass this procedure.
3. This product is used for indoor.
4. Unplug from electrical supply source before cleaning.
5. If the power cord is damaged, contact your local qualified electrician to install an appropriate replacement cord to prevent any injury or damage.
6. This appliance is not intended for use by persons (including children) with reduced physical, sensory or mental capabilities, or lack of experience and knowledge, unless they have been given supervision or instruction concerning use of the appliance by a person responsible for their safety.
7. Children should be supervised to ensure that they do not play with the appliance.

RULES FOR SAFE OPERATION

1. Never insert fingers, pencils, or any other object through the guard when fan is running.
2. Disconnect the fan when moving from one location to another.
3. Disconnect the fan when removing guards for cleaning.
4. Be sure fan is on a stable surface when operating to avoid overturning.
5. DO NOT use fan in window. Rain may create electrical hazard.
6. The fan is for commercial use only.
7. Do not leave the fan running unattended.

OPERATING INSTRUCTIONS

Fan Operation: Always operate the fan in the upright position following all instructions and recommendations listed in this manual.

Fan Connection: Plug fan directly into 120-volt A.C., 60 Hz wall outlet. Be sure plug fits tightly in outlet. A loose connection may cause overheating and damage to the plug or fan.

Note: To prevent overloading a circuit, do not plug the fan into a circuit that is servicing other electrical needs.

Oscillation and Speed Control: While facing the fan, pull the left string for oscillation and pull the right string on the motor to set desired setting.

To Adjust Airflow Upward or Downward: Loosen the position screw first and then loosen the pivot nut. Tilt motor to the desired angle then firmly tighten the pivot nut first and then tighten the position screw.

ASSEMBLE INSTRUCTIONS

Wall Installation Instructions:

Use wall bracket of wall mount assembly as a template for locating the holes to be drilled on mounting surface.

After determining the hole locations, use an appropriate sized drill bit and, drill holes through mounting surface. It is recommended that a minimum of grade 5 fasteners be used. The following are acceptable surfaces for mounting wall mount assembly.

STEEL SURFACE - When mounting to a steel surface, such as vertical I- beam, drill through holes at pre-marked locations, using a 9/32" drill bit. Attach wall mount assembly to mounting surface using 1/4"-20 hex screw, in combination with 1/4" flat washers, 1/4" lock washers, and 1/4"-20 hex nuts.

MASONRY SURFACE - When mounting to a masonry surface use a 1/4" expansion type bolt or 1/4" masonry lag with shield designed to handle the weight of this fan. Drill holes at pre-marked locations using appropriate sized drill bit as recommended for the fastener.

NOTE: Due to the varying methods of mounting, mounting hardware is not supplied.

Fan Assembly Instructions:

1. Install the wall bracket to the wall per the instruction below, making sure the installation can support the fan.
2. Attach the angle support bracket to the wall mount bracket, using the bolt, washer and nut provided.
3. Attach the back guard to the fan motor, using the four screws and washers provided.
4. Attach the fan blade to the motor shaft and tighten the set screw securely to hold it in place.
5. Attach the front guard to the back guard using the screws provided.
6. Attach motor to angle support bracket using the nut bolts provided.

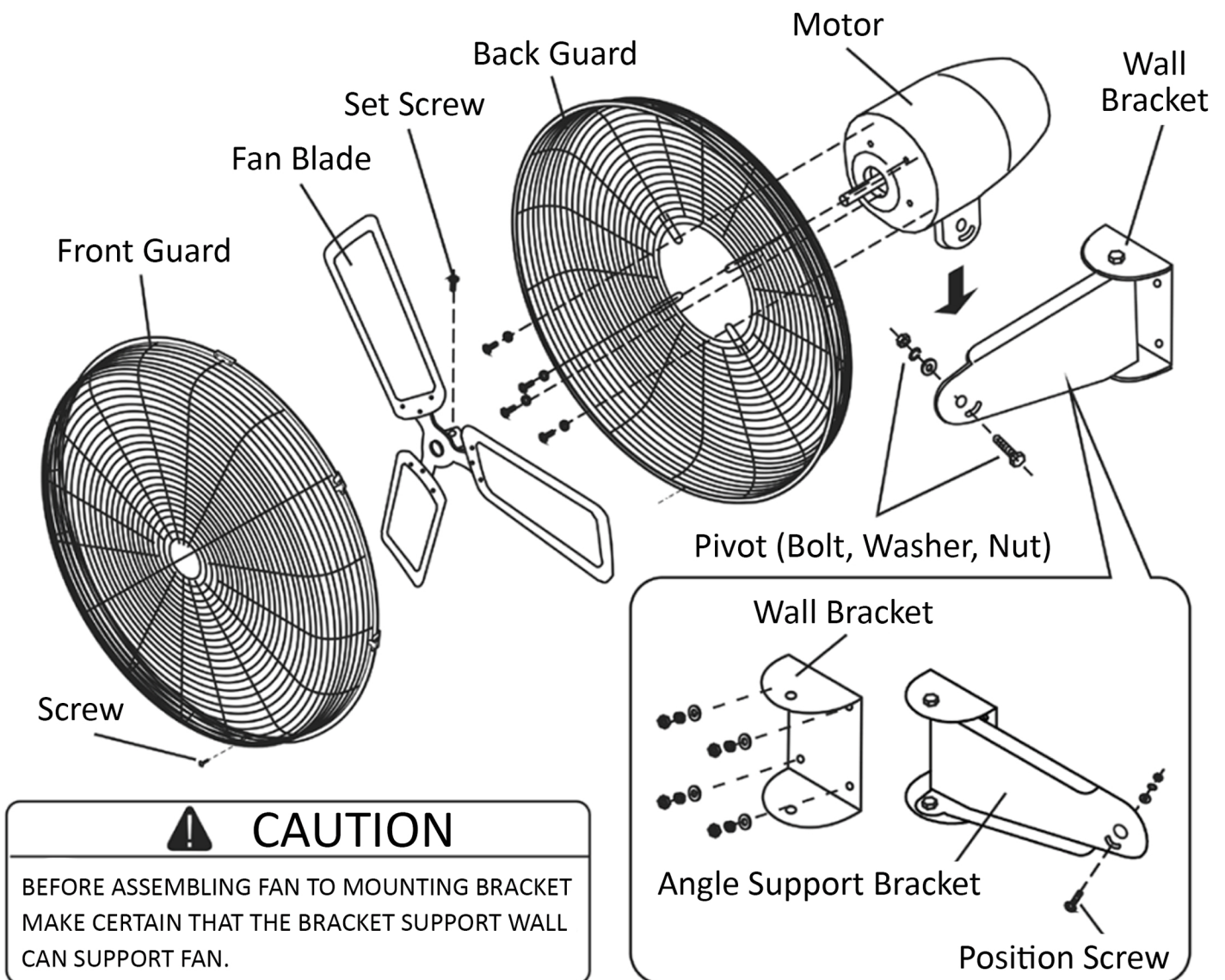

CARE AND MAINTENANCE

Cleaning: CAUTION - Before cleaning the fan be sure to disconnect power cord from the plug. Clean the guard surface with a clean damp cloth. Do not use harsh chemical or abrasive cleaners. **DO NOT IMMERSE THE FAN OR ANY WIRES IN WATER.** Replace front guard before fan use.

Allow fan to dry completely before use. Periodic guard cleaning with a vacuum will prevent dust build up. The motor is sealed and does not require any interior maintenance, cleaning or lubrication.

Maintenance: The Internal motor bearings are permanently lubricated at the factory and do not require any additional lubrication.

Repair: DO NOT OPERATE THE FAN WITHOUT THE GUARD IN PLACE. DO NOT USE THE FAN IF IT HAS MALFUNCTIONED OR BECOME DAMAGED IN ANY WAY.

Storage: Keep original carton for storage of the fan. Coil and tie the power cord to avoid damage during storage.

BANVIL LIMITED WARRANTY

Banvil warrants to the original purchaser that this product is free from defects in materials and workmanship for a period of 12 months from the date of purchase from Banvil, or 24 months from the date of manufacture, whichever occurs first.

In the event of such a defect, Banvil will, at its discretion, repair or replace the product. To qualify for warranty service, please contact **returns@banvil2000.com** with the reason for return, supporting pictures, and proof of purchase. If the issue is deemed warranty-related, the product must be returned prepaid to:

Banvil

470 Industrial Ave.
Woodstock, ON N4S 7L1

This warranty does not cover labor costs or shipping of the product back to Banvil. The warranty is void if the product has been improperly installed, abused, or altered in any way.

Banvil limits the duration of any implied warranties and excludes any liability for incidental or consequential damages arising from the breach of any warranty on this product.